

# PROPOSED HIGHWAY LANDSCAPE DEVELOPMENT PROJECT

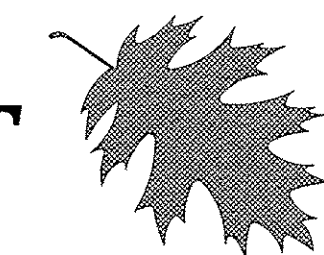

PROJECT: Landscape Enhancement Projects, Wallace, North Carolina

T.I.P. #	STATE PROJECT W.B.S. #	SHEET #	SHEET # TOTAL
	3703.3.24	L1	9
FED. PROJ. #	DESCRIPTION		DIVISION
	landscape		3

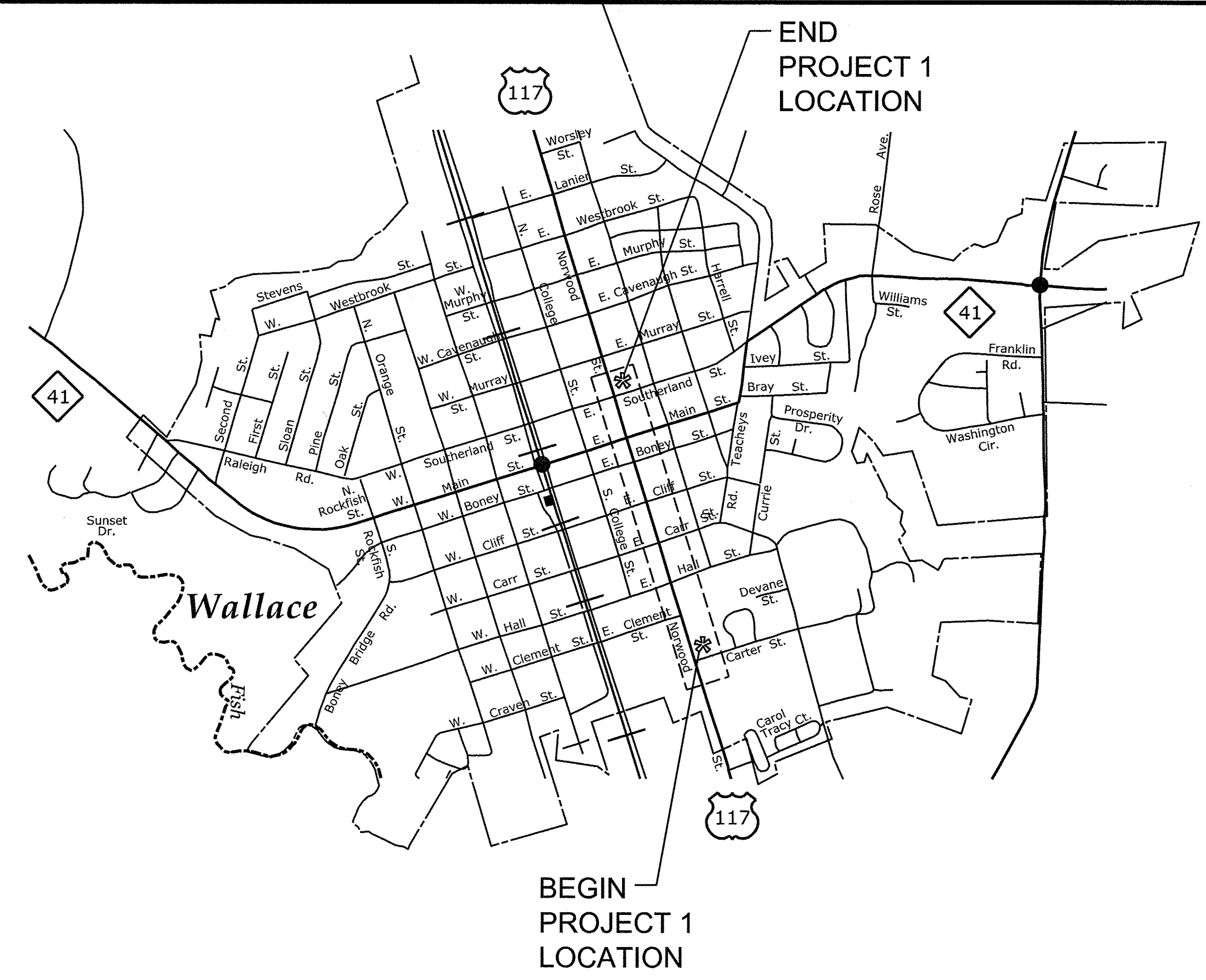

### STREETSCAPE CONSTRUCTION NOTES:

1. A SURVEY WAS NOT PERFORMED FOR THIS PROJECT. THE PLANS WERE CREATED FROM AERIAL PHOTOGRAPHY. CONTRACTOR WILL NEED TO FIELD VERIFY ALL EXISTING FEATURES.
2. CONTRACTOR TO IDENTIFY ALL SUBSURFACE UTILITIES PRIOR TO WORK. CONTRACTOR IS RESPONSIBLE FOR THE PROTECTION OF ALL UTILITIES.
3. REMOVE EXISTING VEGETATION WHERE PLANTINGS ARE PROPOSED (IN PLANTING STRIP). PREPARE BED BY INCORPORATING 4" OF TOPSOIL.
4. THE CONTRACTOR IS RESPONSIBLE FOR THE PROTECTION OF ALL DRIVEWAYS AND DRIVEWAY APRONS.
5. ALL NEW PAVEMENT SHALL MEET THE LINE AND GRADE OF EXISTING PAVEMENT.



### CONVENTIONAL SYMBOLS

County Line	-----
City or Town Line	-----
Exist. Right of Way Line Marker	-----▲-----
Prop. Right of Way Line Marker	-----▲-----
(By Others)	-----▲-----
Prop Right of Way Line Marker	-----▲-----
(By Contract)	-----▲-----
Exist. Control of Access Line	-----○-----
Prop. Control of Access Line	-----○-----
Property Line	-----
Easement Line	-----
Slope Stake Line	-----
Exist. Fence	-----
Prop. Woven Wire Fence	-----
Prop. Chain Link Fence	-----
Exist. Road	-----
Prop. Road	-----
Guardrail	-----
Survey Line	-----
Denotes Line Equality	-----
Bridge	-----
Culvert	-----
Railroad	-----
Woods	-----
Exist. Telephone Pole	-----
Prop. Telephone Pole	-----
Tower Pole and Line	-----
Exist. Power Pole	-----
Prop. Power Pole	-----
Sanitary Sewer Line	-----
Water Line	-----
Gas Line	-----
Picnic Shelter	-----
Regeneration	-----
Reforestation	-----

### INDEX OF SHEETS:

- L1 ... TITLE SHEET
- L2 ... PROJECT 1
- L3 ... PROJECT 1
- L4 ... PROJECT 1
- L5... PROJECT 1
- L6... PROJECT 1
- L7... PROJECT 1
- L8... DETAILS
- L9... DETAILS

PREPARED BY: NN DATE: FEB/2013

### REVISIONS

DATE	DESCRIPTION

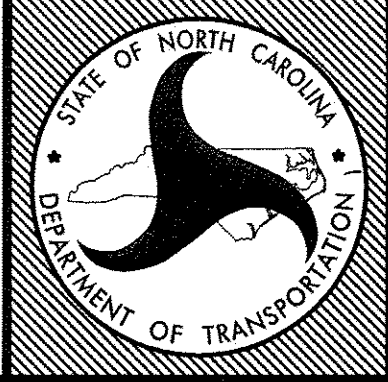
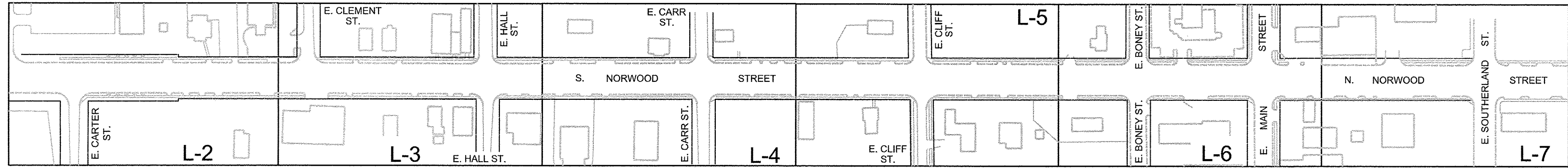

STATE OF  
**NORTH CAROLINA**  
DEPARTMENT OF TRANSPORTATION

LOCATION: Wallace, North Carolina  
TYPE of WORK: Landscape Enhancement Projects  
COUNTY: Duplin



2004 American Standard for Nursery Stock  
2012 NCDOT STANDARD SPECIFICATIONS  
PREPARED IN THE OFFICE OF:  
**ARCADIS**  
801 Corporate Center Drive, Suite 300  
Raleigh, NC 27607-5073  
Tel: 919/854-1282 Fax: 919/854-5448 NC License No. C-1869

\$\$\$\$\$SYTIME\$\$\$\$\$  
\$\$\$\$\$DGN\$\$\$\$\$  
\$\$\$\$\$USERNAMIE\$\$\$\$\$

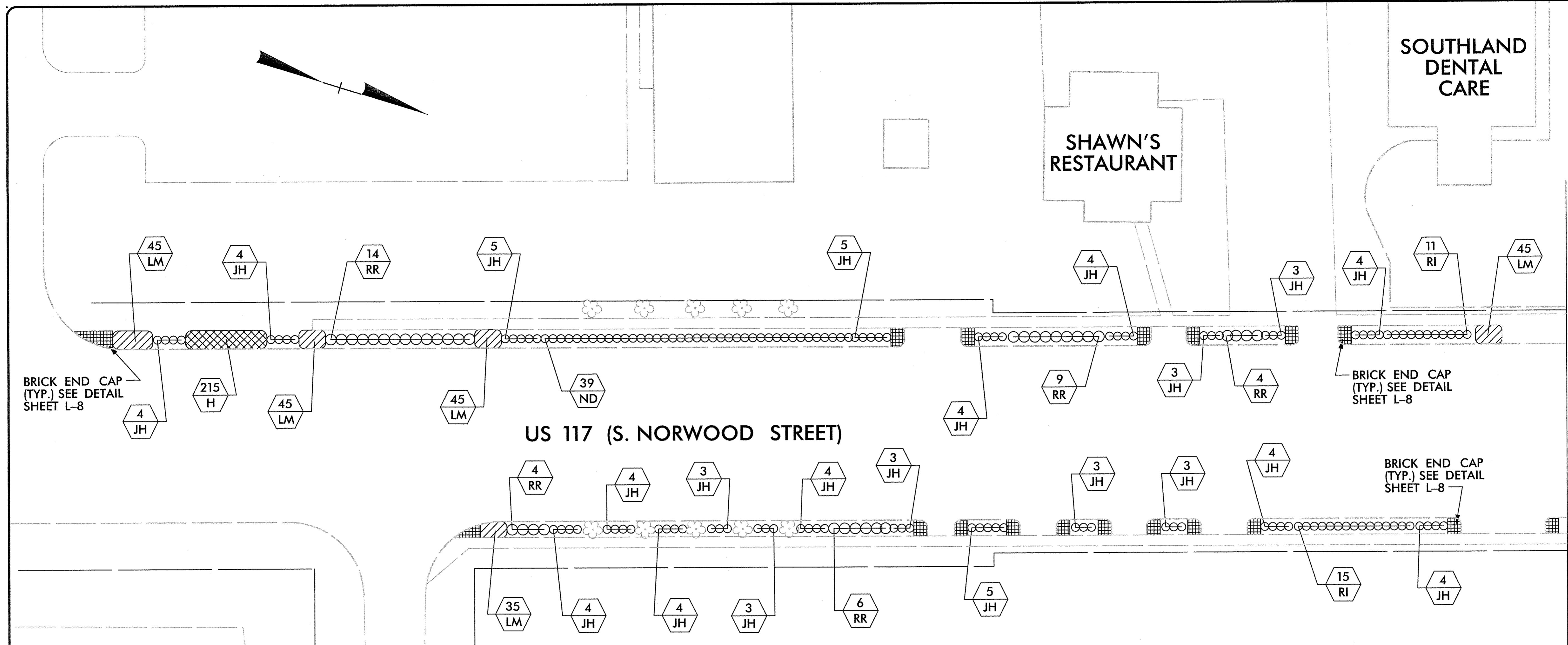

US 117 (S. NORWOOD STREET)

E. CARTER STREET

MATCH LINE SEE SHEET L-3

SUMMARY OF PROJECT QUANTITIES

TYPE	QUANTITY	UNIT	SEC	SYMBOL	BOTANICAL NAME	COMMON NAME	CALIPER	HEIGHT	SPREAD	ROOT	COMMENTS
SHRUBS	76	EA	1670	JH	<i>Juniperus horizontalis</i> <i>Bar Harbor</i>	Bar Harbor Juniper			15" - 18"	CONT.	36" O.C. SPACING
	39	EA	1670	ND	<i>Nandina domestica</i> <i>Gulf Stream</i>	Gulf Stream Nandina		18" - 24"	15" - 18"	CONT.	36" O.C. SPACING
	26	EA	1670	RI	<i>Raphiolepis indica</i> <i>Georgia Petite</i>	Georgia Petite Indian Hawthorne		18" - 24"		CONT.	36" O.C. SPACING
	37	EA	1670	RR	<i>Rosa x red</i> <i>'Double Knock-out'</i>	Red Knock-out Roses				3 GAL. CONT.	48" O.C. SPACING
GROUND COVER / ORNAMENTAL GRASSES	215	EA	1670	H	<i>Hemerocallis</i>	Day Lilly				1 GAL.	12" O.C. SPACING
	225	EA	1670	LM	<i>Liriope muscari</i>	Big Blue Liriope				1 GAL.	15" O.C. SPACING
					DESCRIPTION						
	575	SF.			BRICK PAVERS						
	7	CY.			TOPSOIL						
	5.5	CY.			MULCH FOR PLANTING						

SYSTE...  
US...  
L...

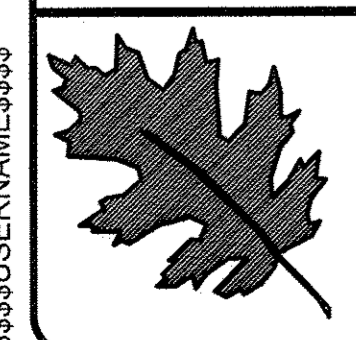

NCDOT - Division 3 - Roadside  
Environmental Unit  
803 Penderlea Highway Burgaw, NC 28425  
Ph: 910-259-4919 Fax: 910-259-2781  
Contact: Joe Chance

**ARCADIS**  
C & M of North Carolina, Inc.  
WWW.ARCADIS-US.COM  
801 Corporate Center Drive, Suite 300  
Raleigh, NC 27607-5073  
Tel: 919/854-1282 Fax: 919/854-5448  
NC License No. C-1869  
Contact: Nick Nikolae

Project 1  
US 117 from Carter Street to E. Southerland St.  
Wallace, NC  
contract #:



prel. design date: February/2013  
checked by & date:  
final design date:

Planting Plan  
Scale: 1" = 20'

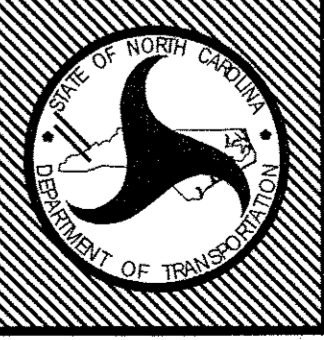

T.I.P. #  
WBS # 3703.3.24  
FED I.D. #  
sheet no: total sheet no:  
**L2 9**

MATCH LINE SEE SHEET L-2

MATCH LINE SEE SHEET L-4

E. CLEMENT ST.

E. HALL ST.

E. HALL ST.

DUPLIN CHRISTIAN OUTREACH MINISTRY

LISA JONES JOHNSON STATE FARM INSURANCE

US 117 (S. NORWOOD STREET)

SUMMARY OF PROJECT QUANTITIES

TYPE	QUANTITY	UNIT	SEC	SYMBOL	BOTANICAL NAME	COMMON NAME	CALIPER	HEIGHT	SPREAD	ROOT	COMMENTS
SHRUBS	94	EA	1670	JH	<i>Juniperus horizontalis</i> 'Bar Harbor'	Bar Harbor Juniper			15" - 18'	CONT.	36" O.C. SPACING
	14	EA	1670	ND	<i>Nandina domestica</i> 'Gulf Stream'	Gulf Stream Nandina		18" - 24"	15" - 18"	CONT.	36" O.C. SPACING
	14	EA	1670	RI	<i>Raphiolepis indica</i> 'Georgia Petite'	Georgia Petite Indian Hawthorne		18" - 24"		CONT.	36" O.C. SPACING
	44	EA	1670	RR	<i>Rosa x red</i> 'Double Knock-out'	Red Knock-out Roses				3 GAL. CONT.	48" O.C. SPACING
GROUND COVER / ORNAMENTAL GRASSES	280	EA	1670	H	<i>Hemerocallis</i>	Day Lilly				1 GAL.	12" O.C. SPACING
	60	EA	1670	MC	<i>Muhlenbergia capillaris</i>	Pink Muhly				1 GAL.	18" O.C. SPACING
					DESCRIPTION						
	780	SF.			BRICK PAVERS						
	5	CY.			TOPSOIL						
	4	CY.			MULCH FOR PLANTING						

BRICK END CAP (TYP.) SEE DETAIL SHEET L-8

BRICK END CAP (TYP.) SEE DETAIL SHEET L-8

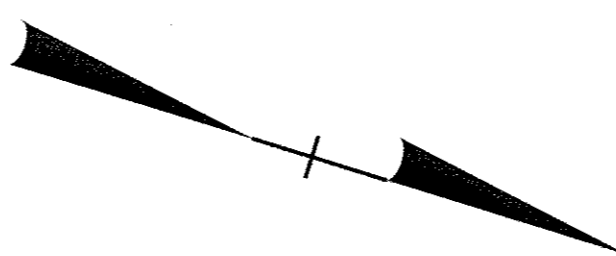

SYSTEMS DESIGN CONSULTANTS, INC. USER NAME: JCHANCE

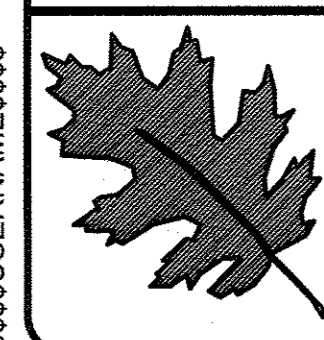

NCDOT - Division 3 - Roadside  
Environmental Unit  
803 Penderlea Highway Burgaw, NC 28425  
Ph: 910-259-4919 Fax: 910-259-2781  
Contact: Joe Chance

**ARCADIS**  
C & M of North Carolina, Inc.  
WWW.ARCADIS-US.COM  
801 Corporate Center Drive, Suite 300  
Raleigh, NC 27607-5073  
Tel: 919/854-1282 Fax: 919/854-5448  
NC License No. C-1869  
Contact: Nick Nikolov

Project 1  
US 117 from Carter Street to E. Southerland St.  
Wallace, NC  
contract #:

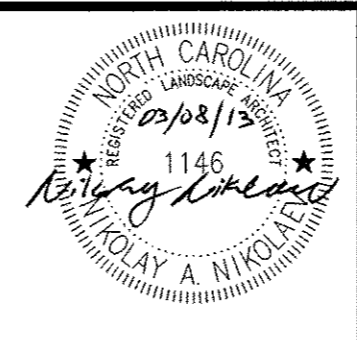

prel. design date : February/2013  
checked by & date :  
final design date :

Planting Plan  
Scale: 1" = 20'

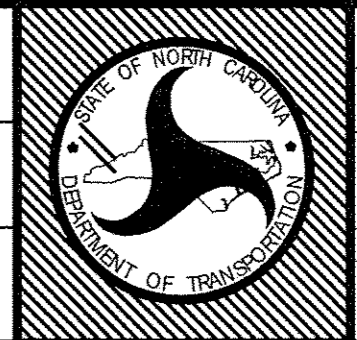

T.I.P. #  
WBS # 3703.3.24  
FED I.D. #  
sheet no : total sheet no :  
**L3 9**

MATCH LINE SEE SHEET L-3

MATCH LINE SEE SHEET L-5

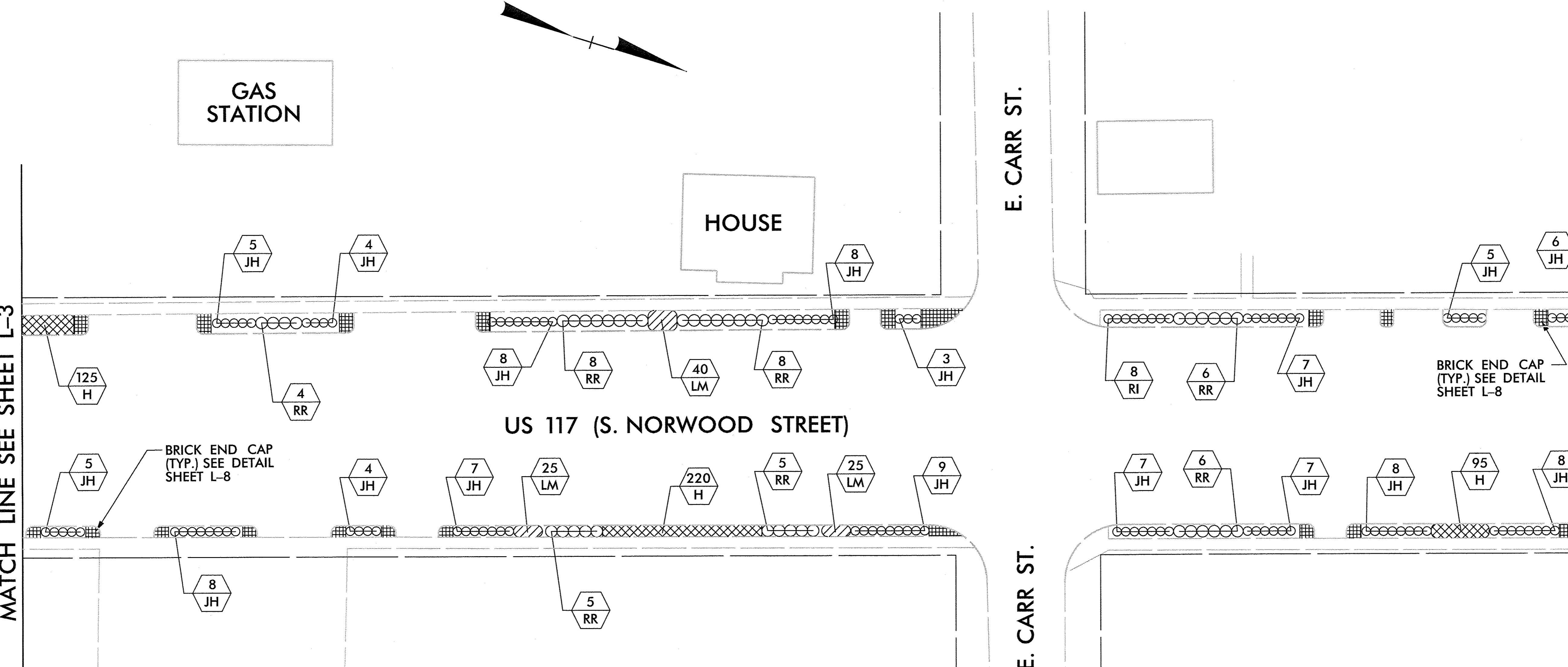

**US 117 (S. NORWOOD STREET)**

**SUMMARY OF PROJECT QUANTITIES**

TYPE	QUANTITY	UNIT	SEC	SYMBOL	BOTANICAL NAME	COMMON NAME	CALIPER	HEIGHT	SPREAD	ROOT	COMMENTS
SHRUBS	109	EA	1670	JH	<i>Juniperus horizontalis</i> Bar Harbor	Bar Harbor Juniper			15" - 18'	CONT.	36" O.C. SPACING
	8	EA	1670	RI	<i>Raphiolepis indica</i> 'Georgia Petite'	Georgia Petite Indian Hawthorne			18" - 24"	CONT.	36" O.C. SPACING
	42	EA	1670	RR	<i>Rosa x red</i> 'Double Knock-out'	Red Knock-out Roses				3 GAL. CONT.	48" O.C. SPACING
GROUND COVER / ORNAMENTAL GRASSES	345	EA	1670	H	<i>Hemerocallis</i>	Day Lilly				1 GAL.	12" O.C. SPACING
	90	EA	1670	LM	<i>Liriope muscari</i>	Big Blue Liriope				1 GAL.	15" O.C. SPACING
					DESCRIPTION						
	685	SF.			BRICK PAVERS						
	4.5	CY.			TOPSOIL						
	3.5	CY.			MULCH FOR PLANTING						

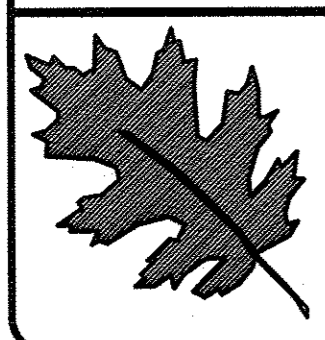
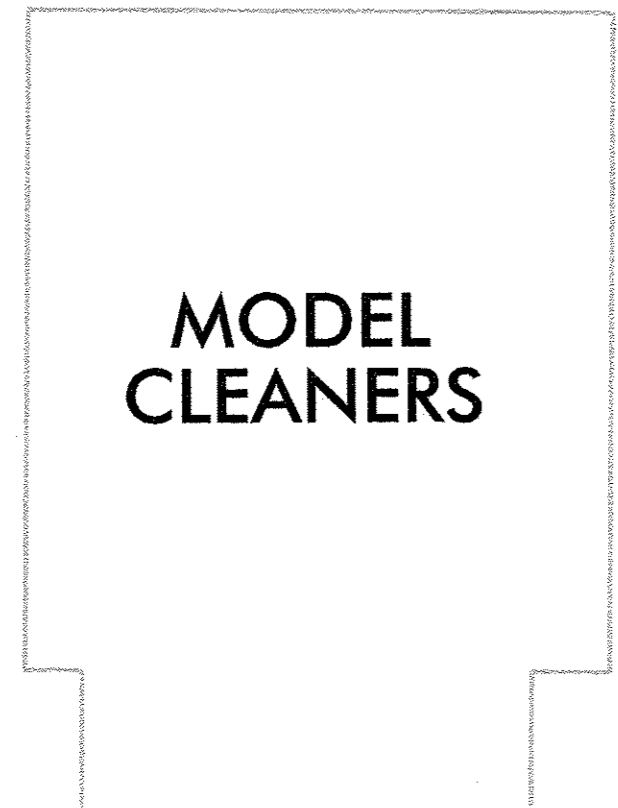

NCDOT - Division 3 - Roadside  
Environmental Unit  
803 Penderlea Highway Burgaw, NC 28425  
Ph: 910-259-4919 Fax: 910-259-2781  
Contact: Joe Chance

**ARCADIS**  
C & W of North Carolina, Inc.  
WWW.ARCADIS-US.COM  
801 Corporate Center Drive, Suite 300  
Raleigh, NC 27607-5073  
Tel: 919/854-1282 Fax: 919/854-5448  
NC License No. C-1869  
Contact: Nick Nikolaev

Project 1  
US 117 from Carter Street to E. Southerland St.  
Wallace, NC  
contract #:

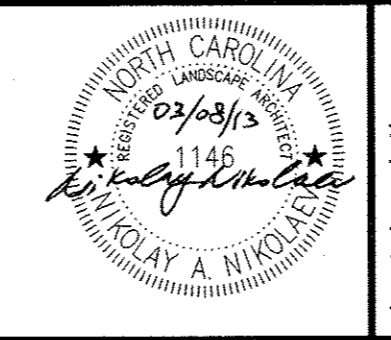

sheet description:  
prel. design date : February/2013  
checked by & date :  
final design date :

Planting Plan  
Scale: 1" = 20'

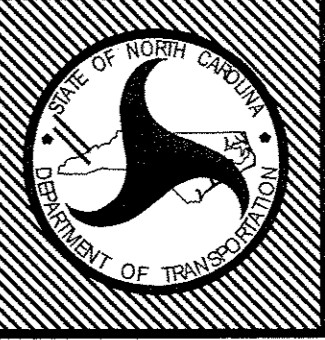

T.I.P. #  
WBS # 3703.3.24  
FED I.D. #  
sheet no :  
total sheet no :  
**L4 9**

MATCH LINE SEE SHEET L-4

MATCH LINE SEE SHEET L-6

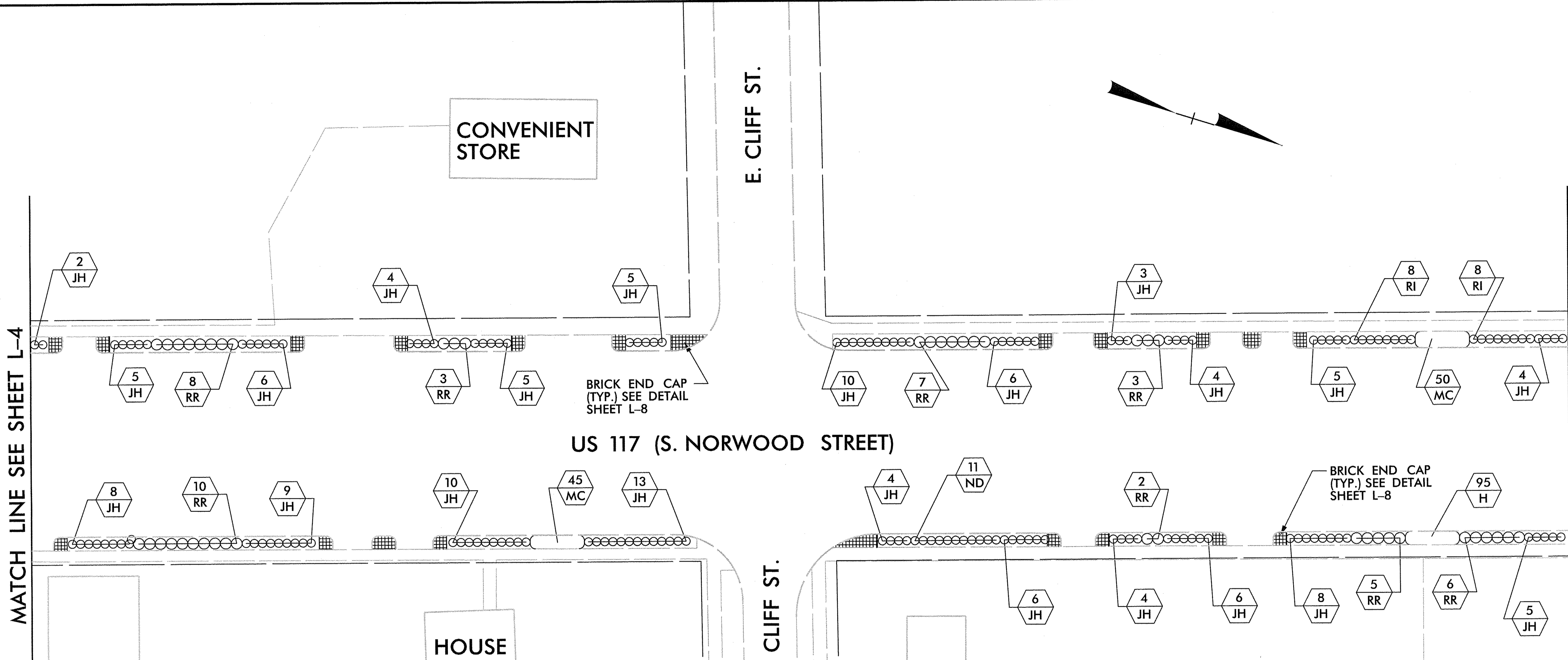



### SUMMARY OF PROJECT QUANTITIES

TYPE	QUANTITY	UNIT	SEC	SYMBOL	BOTANICAL NAME	COMMON NAME	CALIPER	HEIGHT	SPREAD	ROOT	COMMENTS
SHRUBS	132	EA	1670	JH	<i>Juniperus horizontalis</i> Bar Harbor	Bar Harbor Juniper			15" - 18"	CONT.	36" O.C. SPACING
	11	EA	1670	ND	<i>Nandina domestica</i> 'Gulf Stream'	Gulf Stream Nandina		18" - 24"	15" - 18"	CONT.	36" O.C. SPACING
	16	EA	1670	RI	<i>Raphiolepis indica</i> 'Georgia Petite'	Georgia Petite Indian Hawthorne		18" - 24"		CONT.	36" O.C. SPACING
	44	EA	1670	RR	<i>Rosa x red</i> 'Double Knock-out'	Red Knock-out Roses				3 GAL. CONT.	48" O.C. SPACING
GROUND COVER / ORNAMENTAL GRASSES	95	EA	1670	H	<i>Hemerocallis</i>	Day Lilly				1 GAL.	12" O.C. SPACING
	95	EA	1670	MC	<i>Muhlenbergia capillaris</i>	Pink Muhly				1 GAL.	18" O.C. SPACING
					DESCRIPTION						
	690	SF.			BRICK PAVERS						
	3.5	CY.			TOPSOIL						
	3	CY.			MULCH FOR PLANTING						

### HOUSE

HOUSE

  
NCDOT - Division 3 - Roadside  
Environmental Unit  
803 Penderlea Highway Burgaw, NC 28425  
Ph: 910-259-4919 Fax: 910-259-2781  
Contact: Joe Chance

  
**ARCADIS**  
C & M of North Carolina, Inc.  
WWW.ARCADIS-US.COM  
801 Corporate Center Drive, Suite 300  
Raleigh, NC 27607-5073  
Tel: 919/854-1262 Fax: 919/854-5448  
NC License No. C-1869  
Contact: Nick Nikolov

Project 1  
US 117 from Carter Street to E. Southerland St.  
Wallace, NC  
contract #:

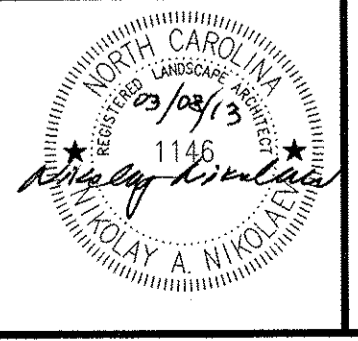

prel. design date : February/2013  
checked by & date :  
final design date :

Planting Plan  
Scale: 1" = 20'

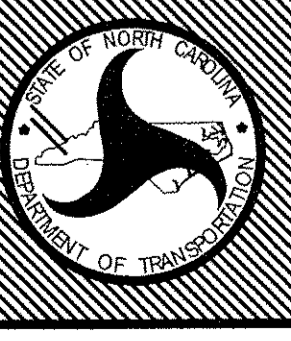

T.I.P. #  
WBS # 3703.3.24  
FED I.D. #  
sheet no : total sheet no :  
**L5** **9**

\*\*\*\*\*



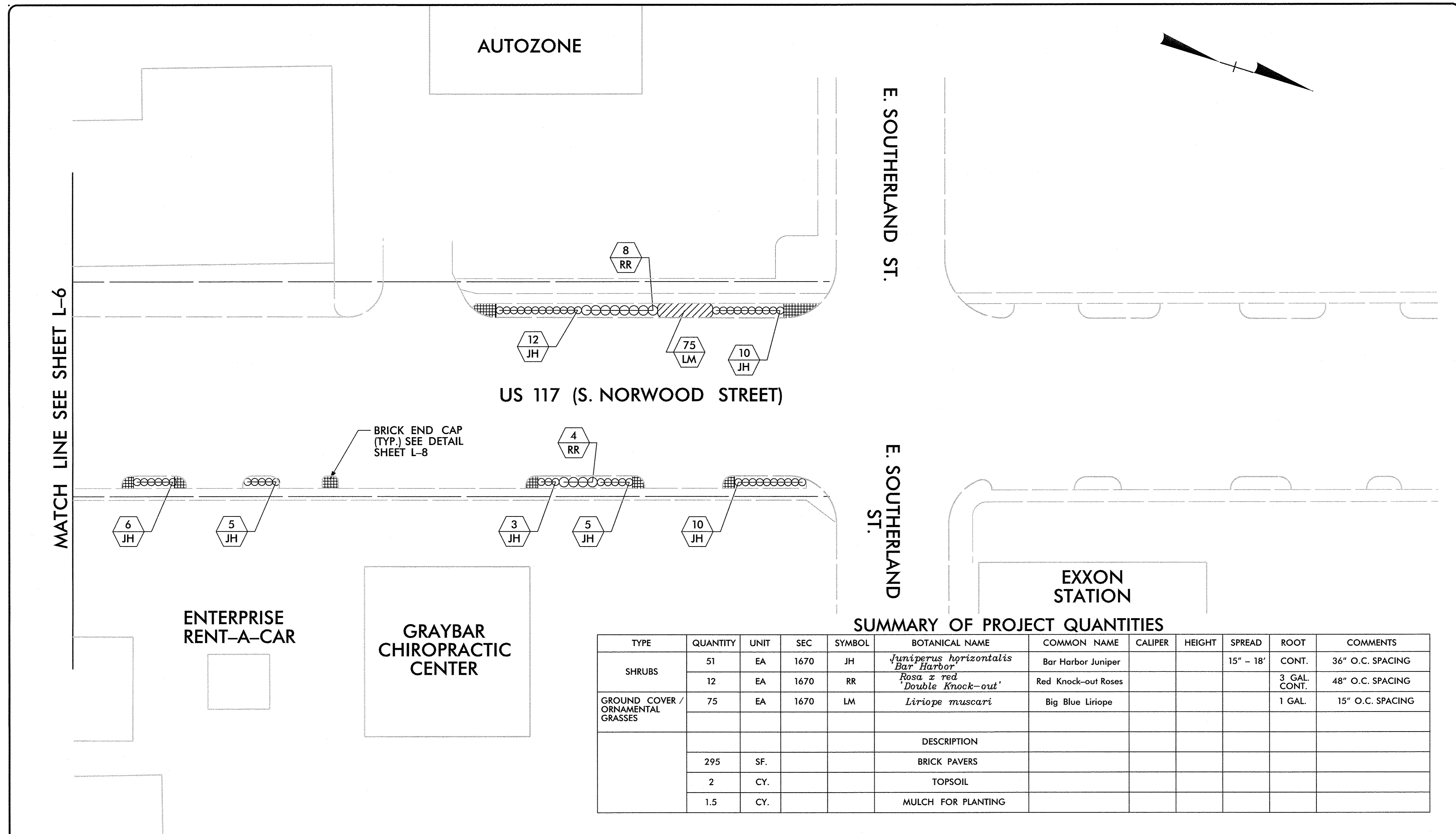

**SUMMARY OF PROJECT QUANTITIES**

TYPE	QUANTITY	UNIT	SEC	SYMBOL	BOTANICAL NAME	COMMON NAME	CALIPER	HEIGHT	SPREAD	ROOT	COMMENTS
SHRUBS	51	EA	1670	JH	<i>Juniperus horizontalis</i> Bar Harbor	Bar Harbor Juniper			15" - 18'	CONT.	36" O.C. SPACING
	12	EA	1670	RR	<i>Rosa x red</i> 'Double Knock-out'	Red Knock-out Roses				3 GAL. CONT.	48" O.C. SPACING
GROUND COVER / ORNAMENTAL GRASSES	75	EA	1670	LM	<i>Liriope muscari</i>	Big Blue Liriope				1 GAL.	15" O.C. SPACING
					DESCRIPTION						
	295	SF.			BRICK PAVERS						
	2	CY.			TOPSOIL						
	1.5	CY.			MULCH FOR PLANTING						

SYSTEM DESIGNED BY: J. CHANCE  
 CHECKED BY: J. CHANCE  
 DATE: 02/09/13



NCDOT - Division 3 - Roadside  
 Environmental Unit  
 803 Penderlea Highway Burgaw, NC 28425  
 Ph: 910-259-4919 Fax: 910-259-2781  
 Contact: Joe Chance



**ARCADIS**  
 G & M of North Carolina, Inc.  
 WWW.ARCADIS-US.COM  
 801 Corporate Center Drive, Suite 300  
 Raleigh, NC 27607-5073  
 Tel: 919/854-1282 Fax: 919/854-5448  
 NC License No. C-1863  
 Contact: Nick Nikolaev

Project 1  
 US 117 from Carter Street to E. Southerland St.  
 Wallace, NC  
 contract #:



sheet description:  
 prel. design date : February/2013  
 checked by & date :  
 final design date :

Planting Plan  
 Scale: 1" = 20'

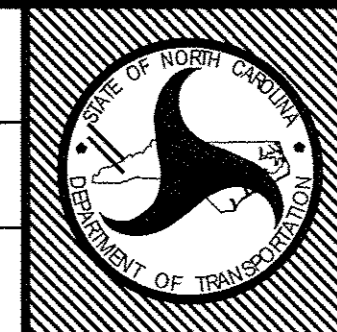

T.I.P. #  
 WBS# 3703.3.24  
 FED I.D. #  
 sheet no: L7 total sheet no: 9

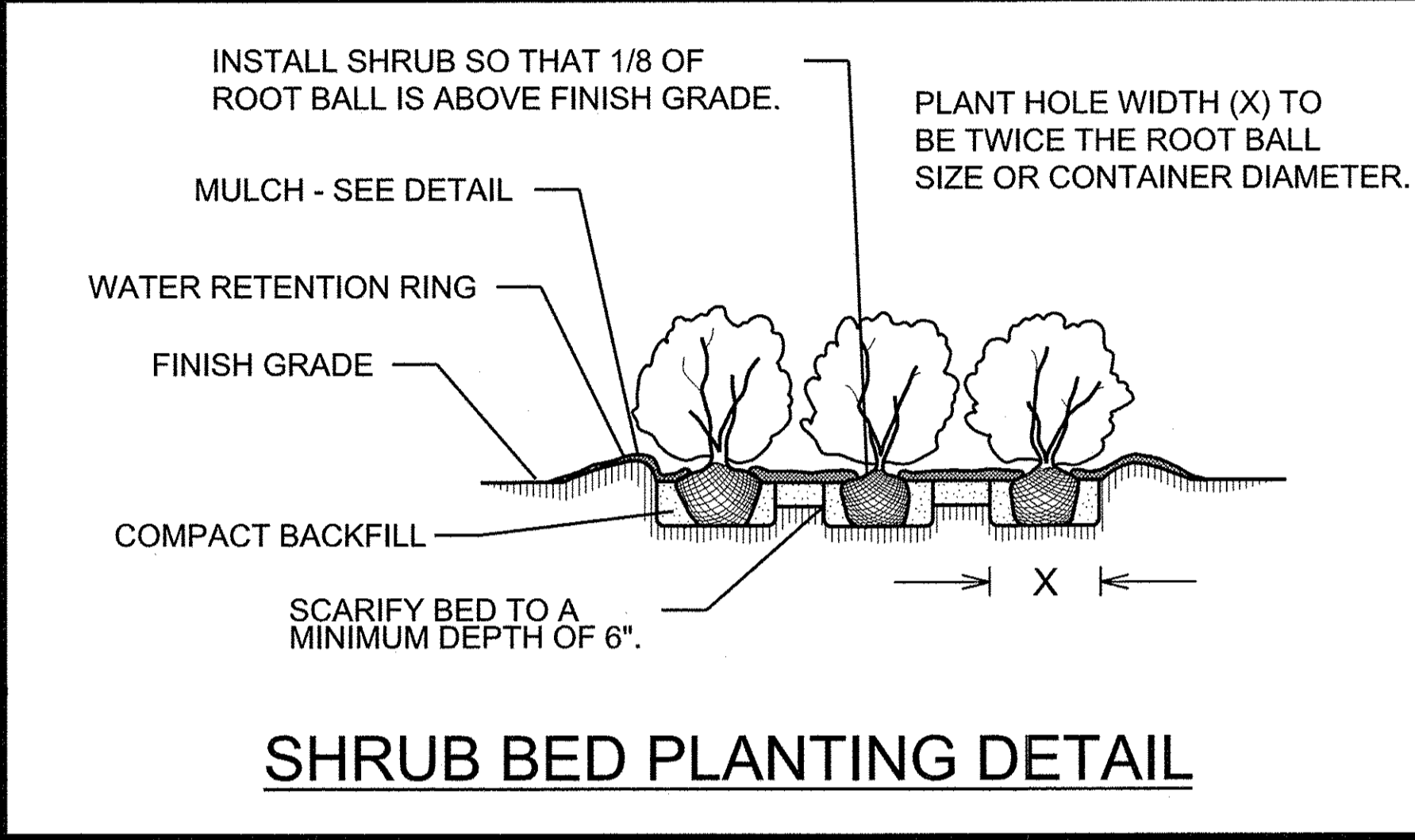
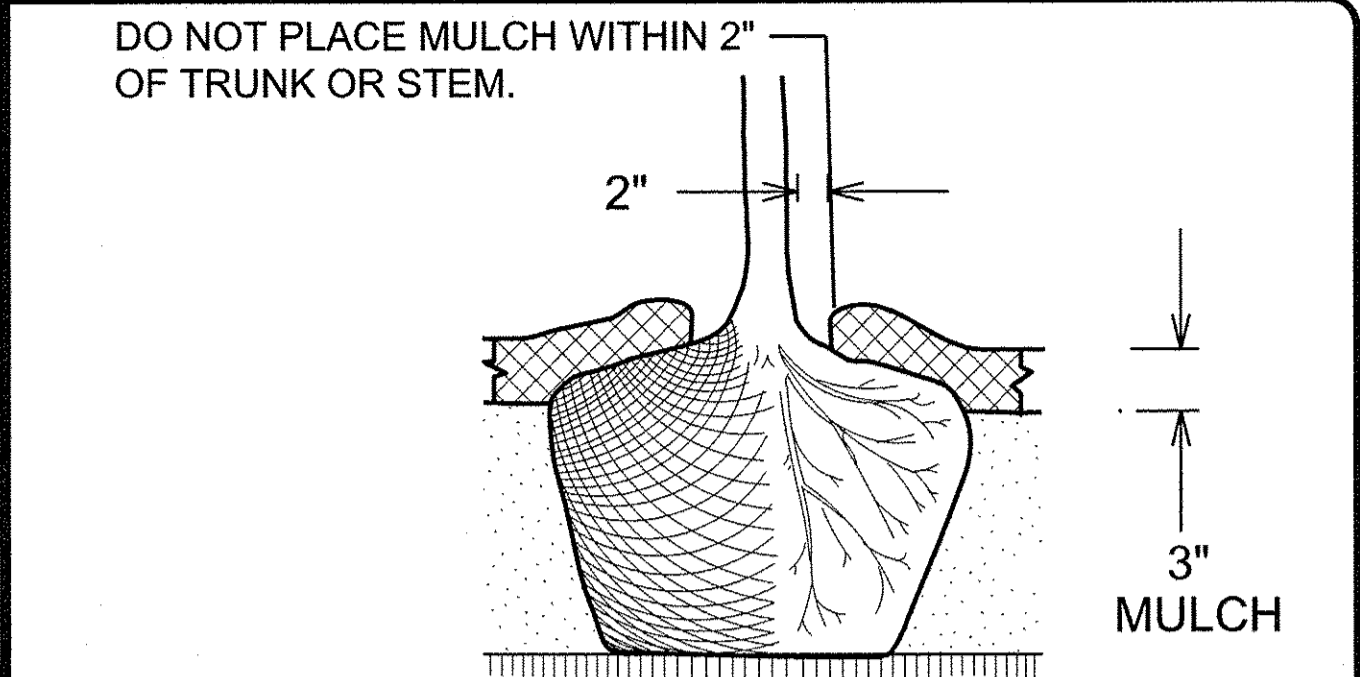
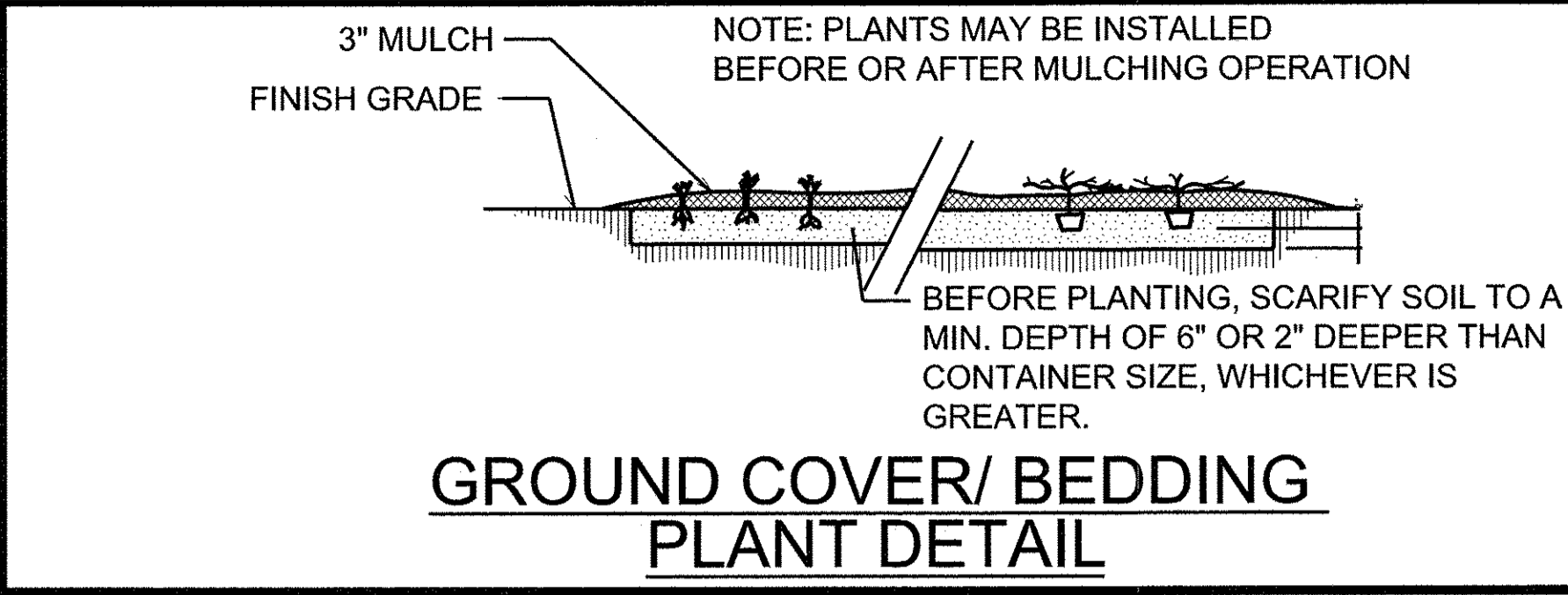
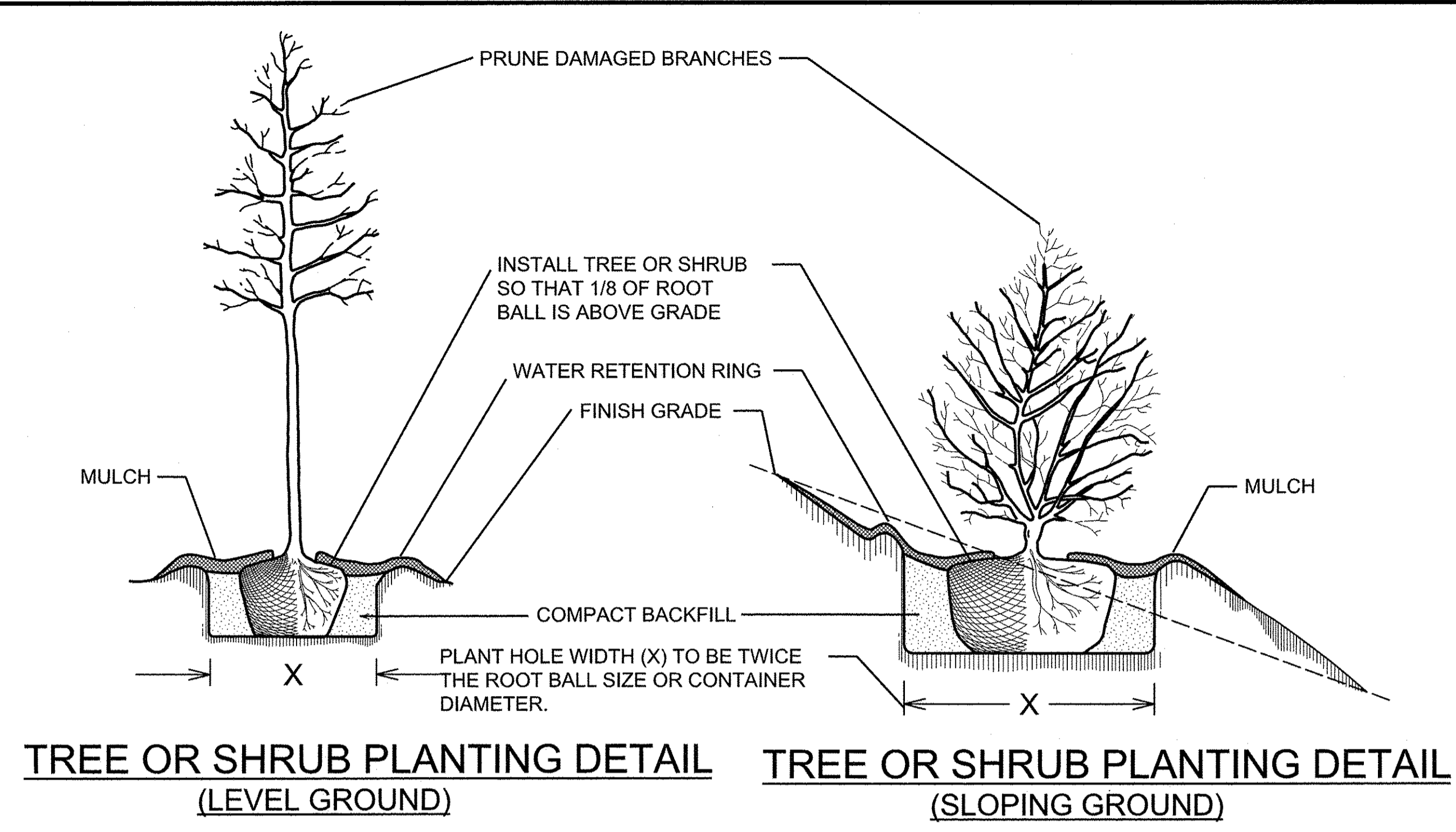

**NOTES:**

- SCHEDULE FOR PLANT HOLE: PLANT HOLE WIDTH (X) TO BE TWICE THE ROOT BALL SIZE OR CONTAINER DIAMETER.
- SEE STANDARD SPECIFICATIONS FOR PLANT BED FUMIGATION AND HERBICIDAL TREATMENT.
- APPLY FERTILIZER AT PLANTING TIME IN THE FORM OF A SLOW RELEASE PELLETT OR TABLET. APPLY AT RATE RECOMMENDED BY MANUFACTURER. BOTH RATE AND FORMULATION MUST BE APPROVED BY FIELD ENGINEER PRIOR TO APPLICATION.
- REMOVE WIRE BASKET AND FOLD BURLAP BACK FROM TOP OF ROOT BALL BEFORE BACKFILLING IS COMPLETE.
- ALL PRUNING TO FOLLOW STANDARD ARBORICULTURAL PRACTICES AS SPECIFIED BY INTERNATIONAL SOCIETY OF ARBORICULTURE.
- DO NOT ATTEMPT TO STRAIGHTEN A TREE THAT HAS BEEN PLANTED AT AN ANGLE WITH THE USE OF STAKING OR GUYING. DIG TREE AND REPLANT TO UPRIGHT POSITION.

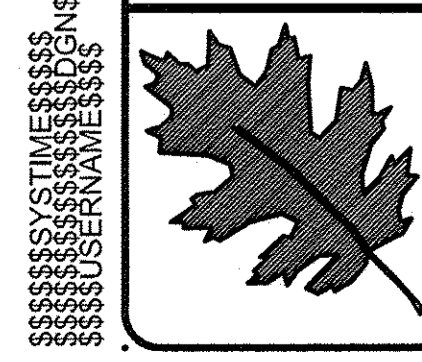
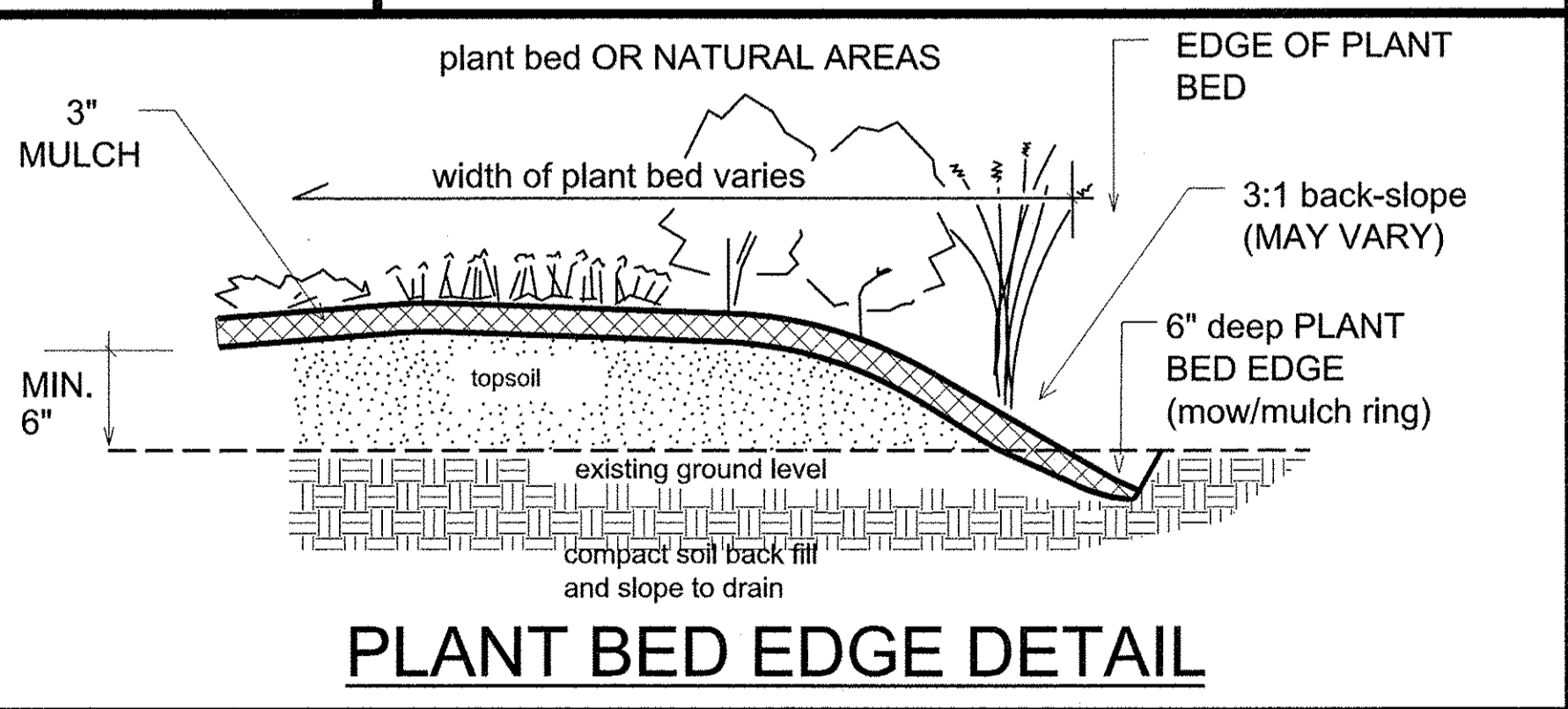
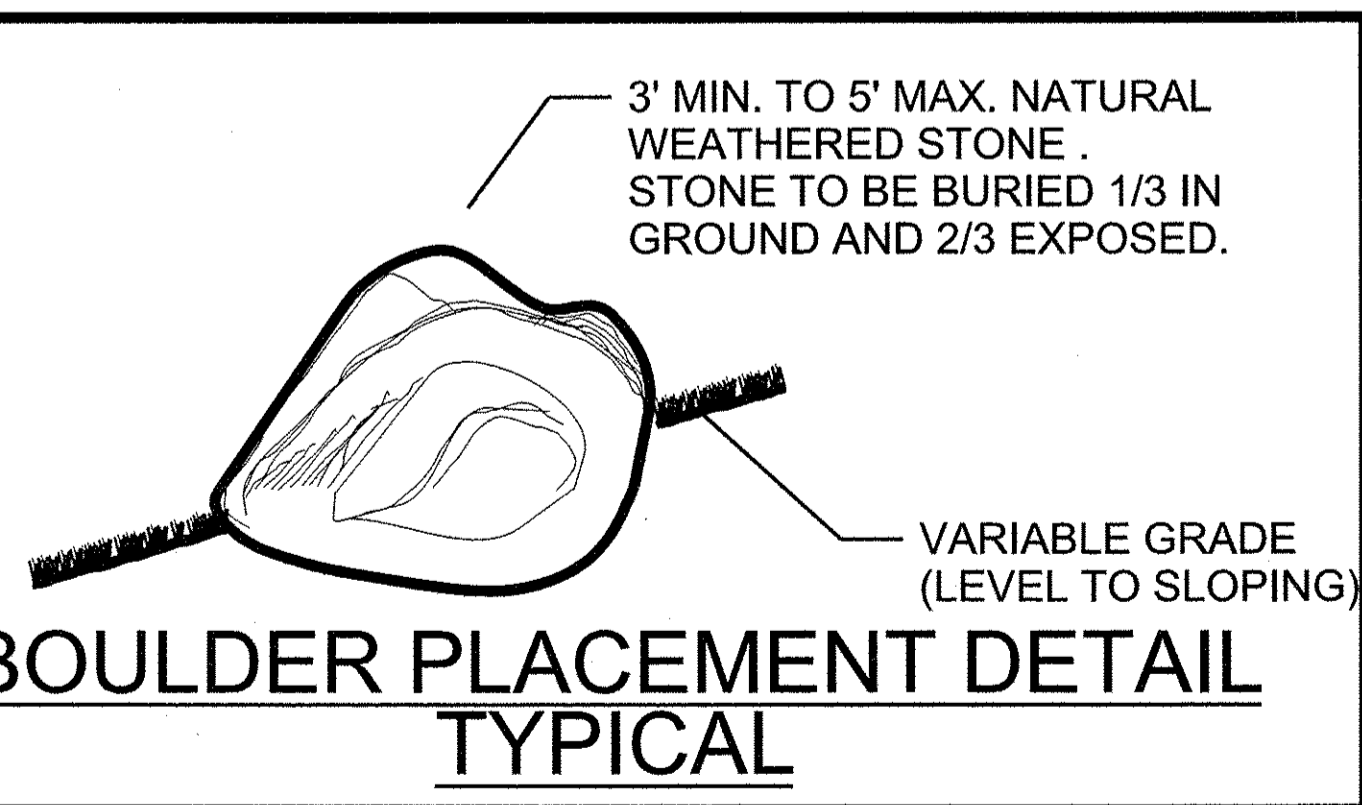
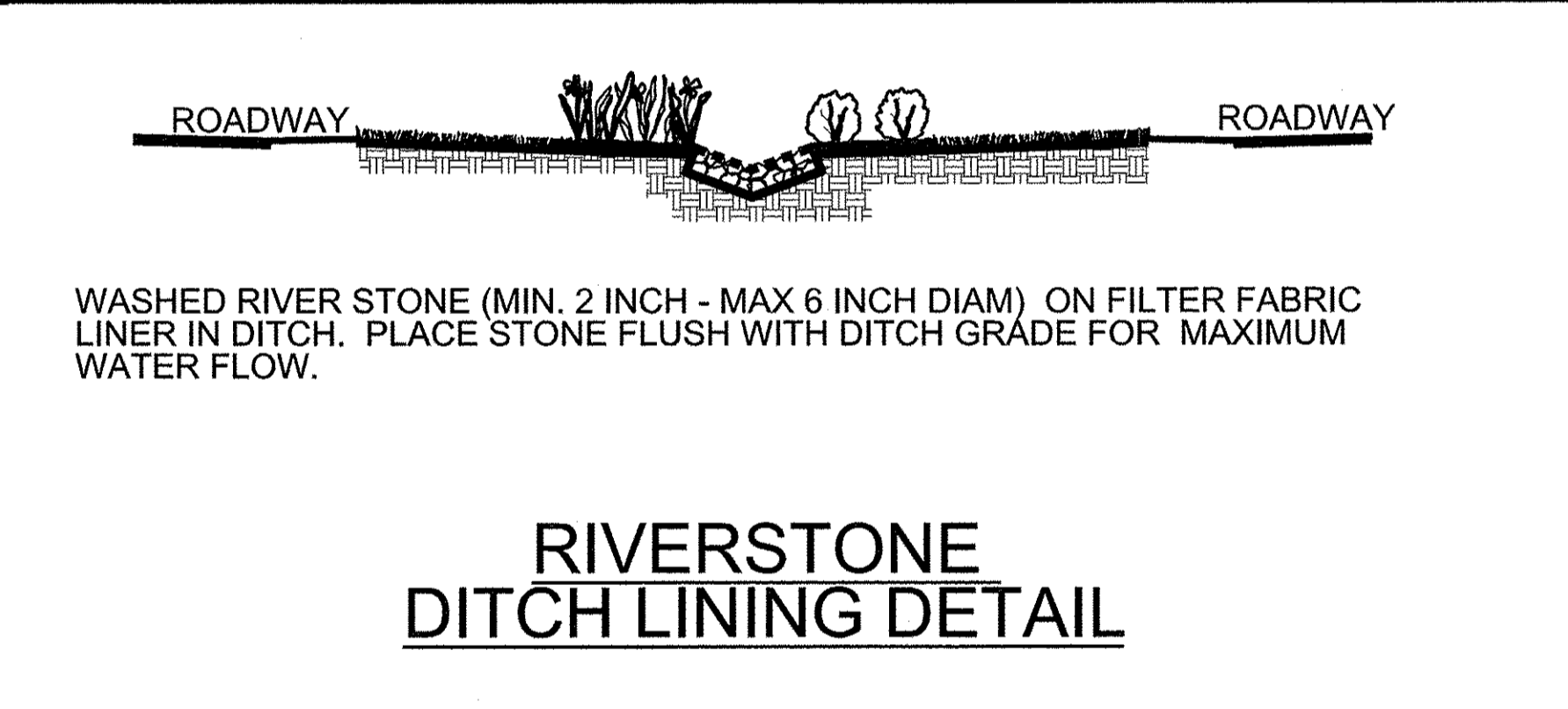
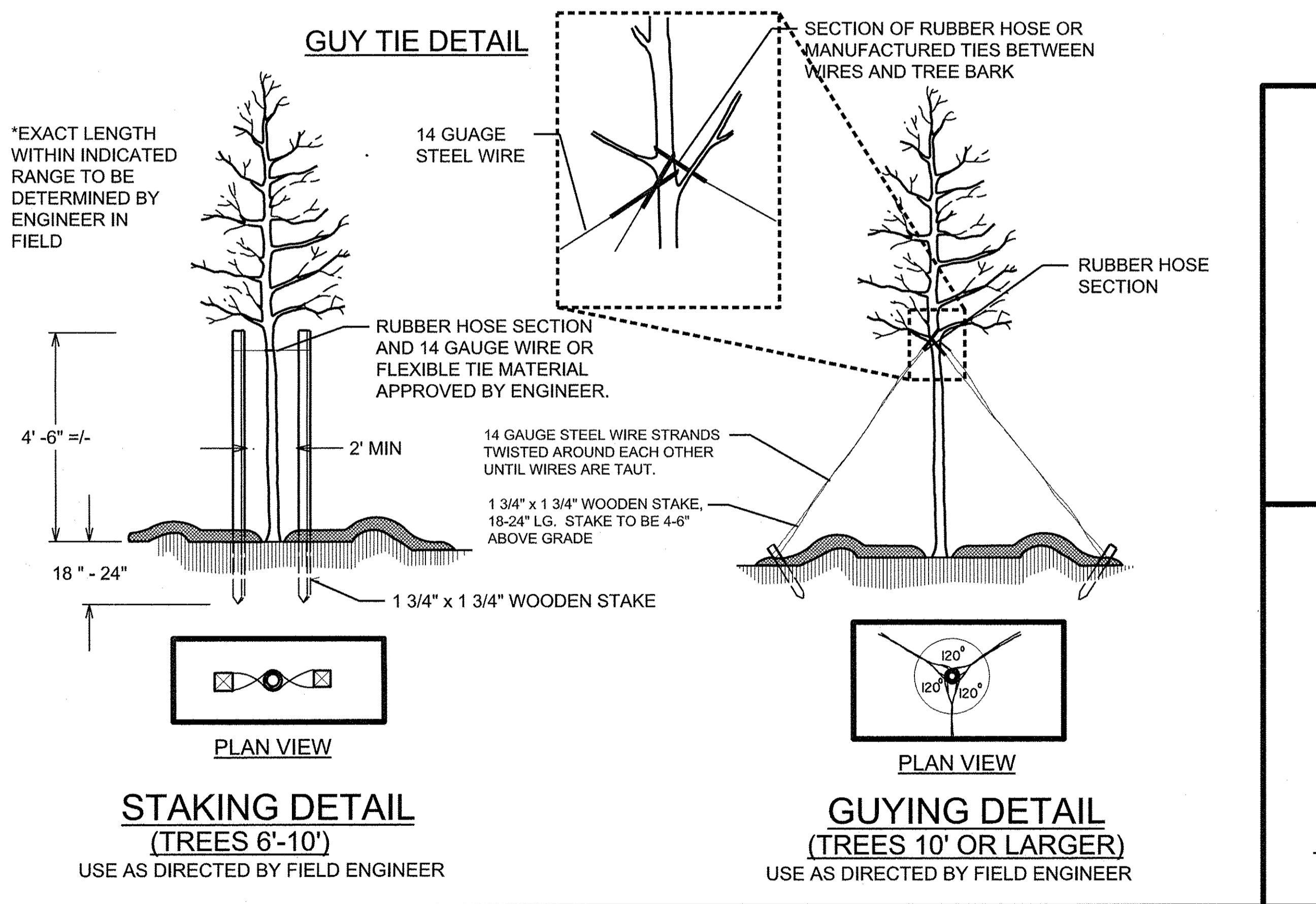

NCDOT - Division 3 - Roadside Environmental Unit  
 803 Penderlea Highway Burgaw, NC 28425  
 Ph: 910-259-4919 Fax: 910-259-2781  
 Contact: Joe Chance

**ARCADIS**  
 C & M of North Carolina, Inc.  
 WWW.ARCADIS-US.COM  
 801 Corporate Center Drive, Suite 300  
 Raleigh, NC 27607-5073  
 Tel: 919/854-1282 Fax: 919/854-5448  
 NC License No. C-1869  
 Contact: Nick Nikolaeov

Landscape Enhancement Projects  
 Wallace, North Carolina  
 Duplin County  
 contract #:

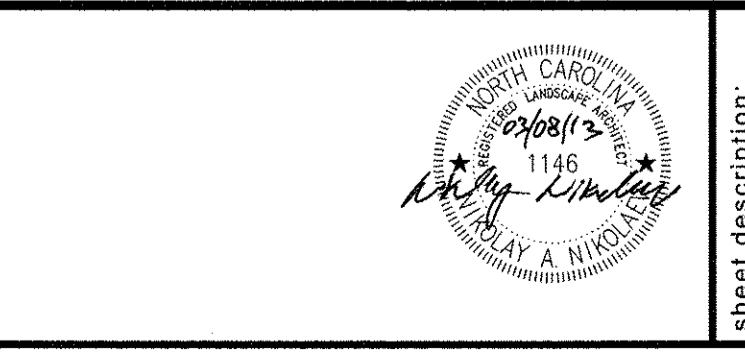

prel. design date : February/2013  
 checked by & date :  
 final design date :

Details

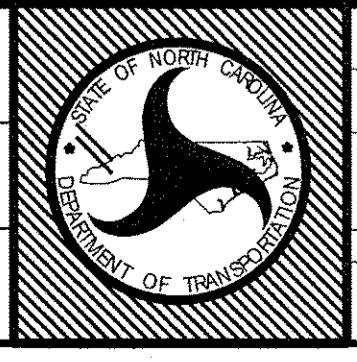

T.I.P. #  
 WBS # 3703.3.24  
 FED I.D. #  
 sheet no : total sheet no :  
**L8 9**



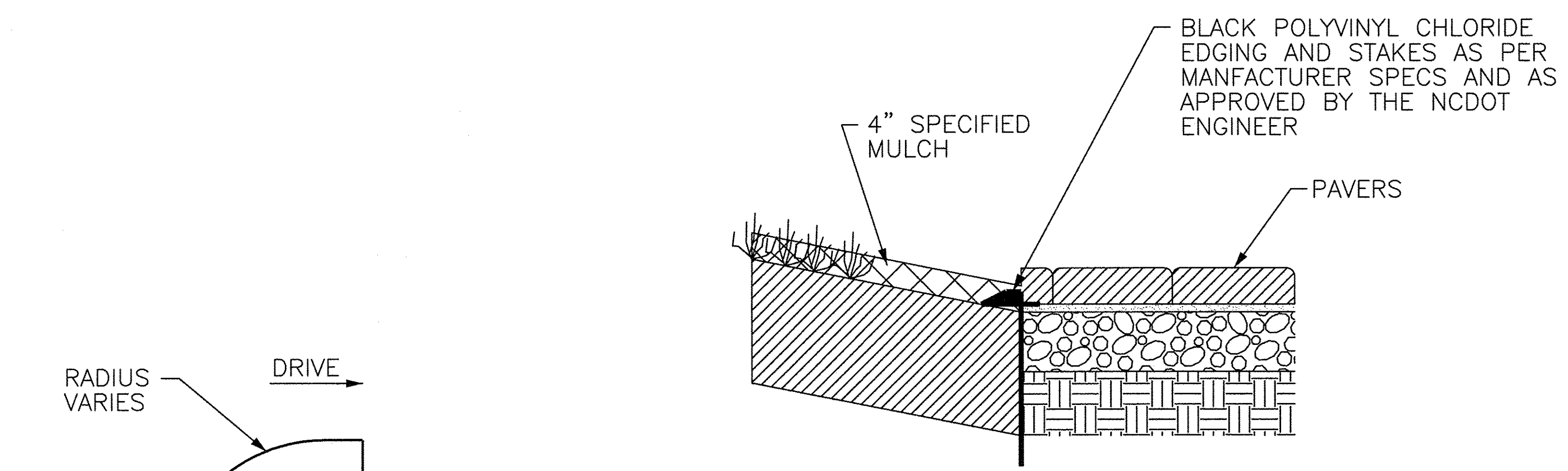

**EDGE RESTRAINT FOR PAVERS DETAIL**

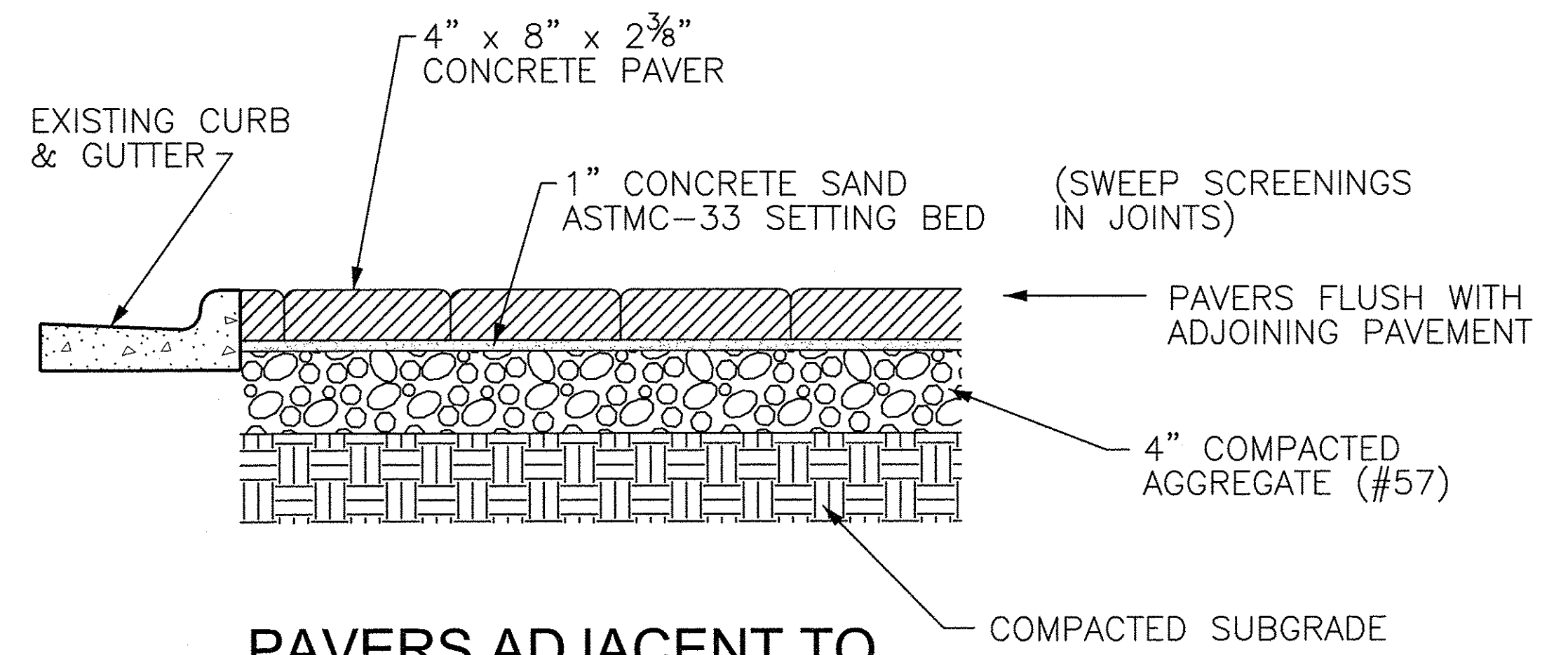

**PAVERS ADJACENT TO CURB DETAIL**

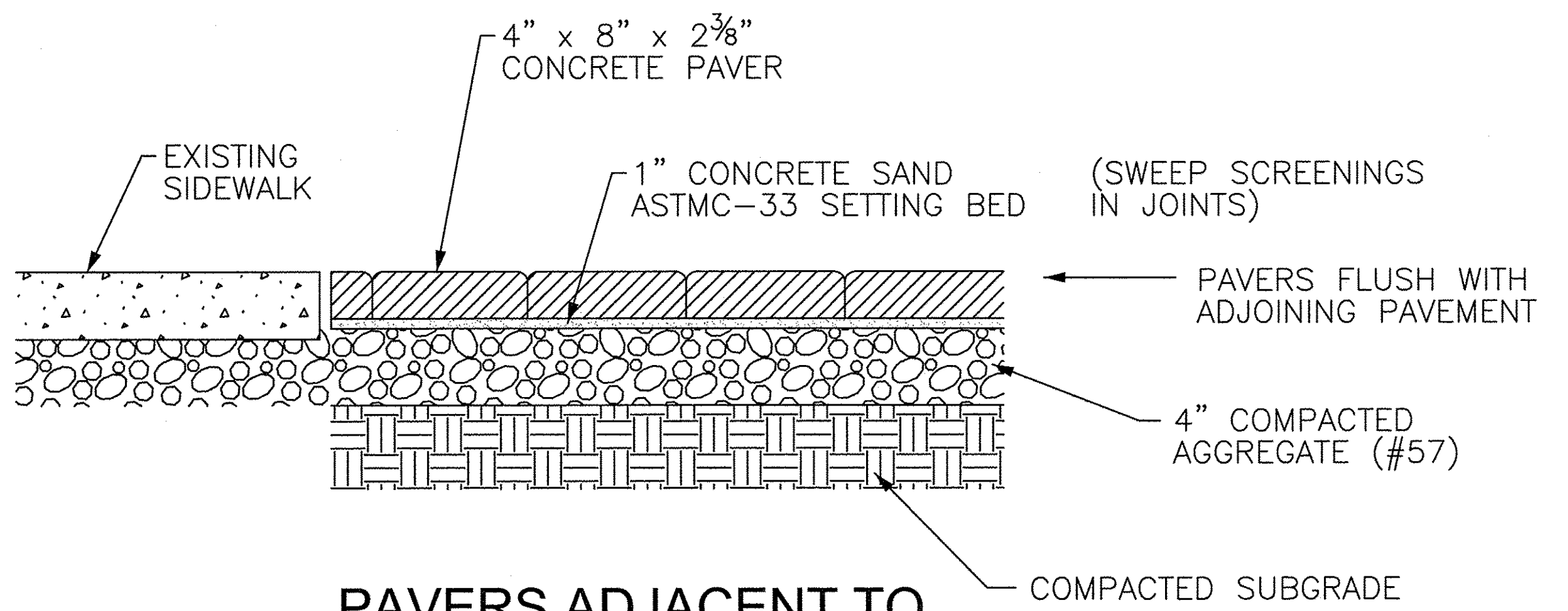

**PAVERS ADJACENT TO SIDEWALK DETAIL**

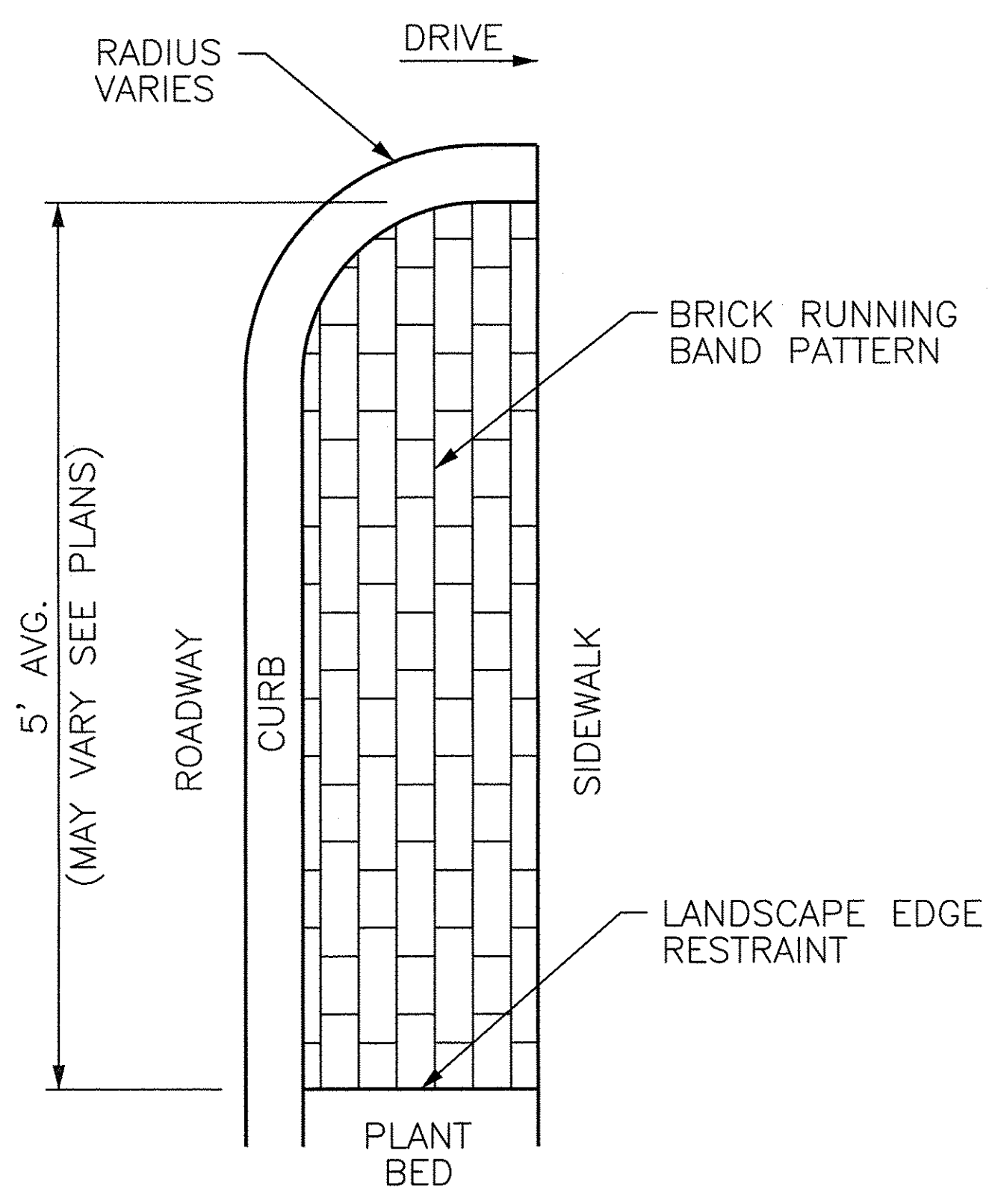

**BRICK END CAP DETAIL**

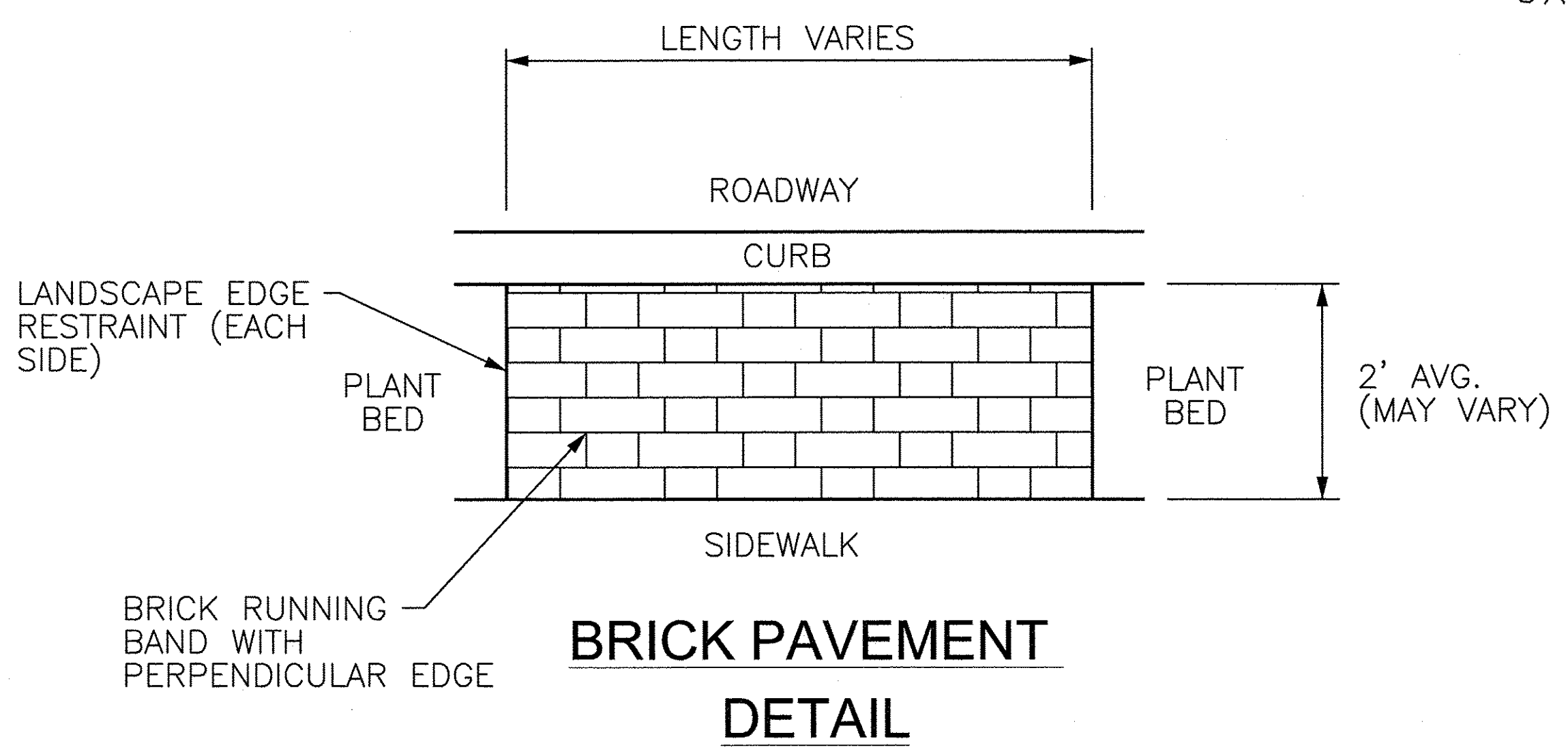

**BRICK PAVEMENT DETAIL**

SYSTEMS  
DESIGN  
SERVICES

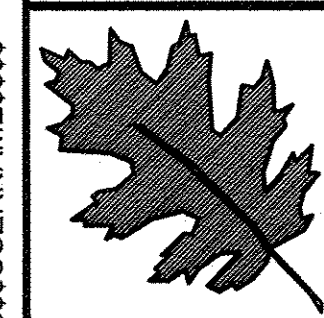

NCDOT - Division 3 - Roadside  
Environmental Unit  
803 Penderlea Highway Burgaw, NC 28425  
Ph: 910-259-4919 Fax: 910-259-2781  
Contact: Joe Chance

**ARCADIS**  
C & M of North Carolina, Inc.  
WWW.ARCADIS-US.COM  
801 Corporate Center Drive, Suite 300  
Raleigh, NC 27607-5073  
Tel: 919/854-1282 Fax: 919/854-5448  
NC License No. C-1869  
Contact: Nick Nikolaev

Landscape Enhancement Projects  
Wallace, North Carolina  
Duplin County  
contract #:



sheet description:	prel. design date : February/2013
	checked by & date :
	final design date :

Details
---------

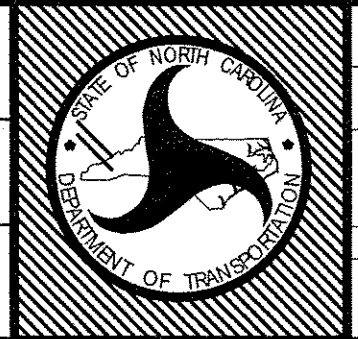

T.I.P. #	
WBS #	3703.3.24
FED I.D. #	
sheet no :	total sheet no :
<b>L9</b>	<b>9</b>